

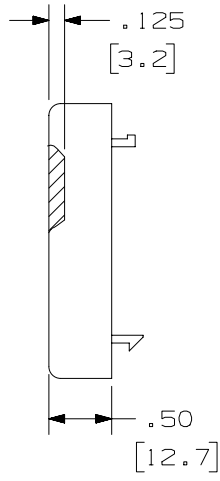

THIS COPY IS PROVIDED ON A RESTRICTED BASIS AND IS NOT TO BE USED IN ANY WAY DETRIMENTAL TO THE INTERESTS OF PANDUIT CORP.

PANDUIT PART NO. *	WEIGHT
MFFPEBL	.04 LB/EACH (20 g/EACH)



NOTES:

- * 1. SEE CURRENT CATALOG FOR ADDITIONAL PART NUMBER SUFFIXES TO INDICATE COLOR AND OR PACKAGE QUANTITY.
- 2. ACCEPTS PANDUIT MODULAR FURNITURE FACEPLATES WHEN DEPTH INSIDE MODULAR FURNITURE BASE IS LIMITED.
- 3. FITS INTO SAME BREAKOUT SIZE AS FACEPLATES.
- 4. DIMENSIONS IN PARENTHESES ARE IN METRIC.

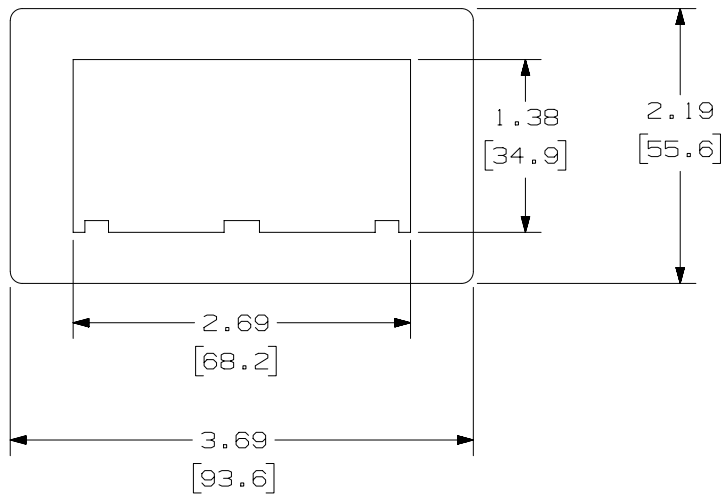

CAD FILENAME/LAYERS		D34518_MFFPEBL_C (D)																	
<h1>PANDUIT</h1> <p>CORP. TINLEY PARK, ILLINOIS</p>																			
<p>MFFP FACEPLATE EXTENDER (MFFPEBL) CUSTOMER DRAWING</p>																			
UNLESS OTHERWISE SPECIFIED, DIMENSIONAL TOLERANCES ARE: $(.X) \pm$ $(.XXX) \pm .010(.3)$ $(.XX) \pm .03(.8)$ ANGLES \pm		UNLESS OTHERWISE SPECIFIED, ALL DIMENSIONS ARE GIVEN IN INCHES, THIRD ANGLE PROJECTION.																	
DRAWN BY: DW		MAT'L:	SCALE: NONE																
DATE: 8-23-93			DRAWING NO. 34518-15																
CHECKED BY:		<table border="1"> <tr> <td>DWG SIZE</td> <td>A</td> </tr> </table>		DWG SIZE	A														
DWG SIZE	A																		
<table border="1"> <tr> <th>REV</th> <th>DATE</th> <th>BY</th> <th>CHK</th> <th>DESCRIPTION</th> <th>ECN</th> <th>CHK</th> <th>CUST</th> <th>SUP</th> </tr> <tr> <td>R</td> <td>8-23-93</td> <td>DW</td> <td></td> <td>RELEASED TO PRODUCTION</td> <td>34518-15</td> <td></td> <td></td> <td></td> </tr> </table>		REV	DATE	BY	CHK	DESCRIPTION	ECN	CHK	CUST	SUP	R	8-23-93	DW		RELEASED TO PRODUCTION	34518-15			
REV	DATE	BY	CHK	DESCRIPTION	ECN	CHK	CUST	SUP											
R	8-23-93	DW		RELEASED TO PRODUCTION	34518-15														

